

LE4-108-XR1

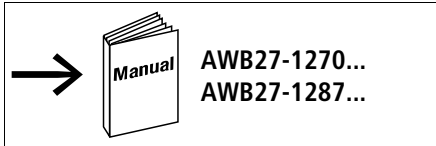

→ Das Gerät ist für den industriellen Einsatz geeignet (→ EN 55011/22 Klasse A).
The device is suitable for use in industrial environments (→ EN 55011/22 Class A).
L'appareil a été conçu pour l'emploi en milieu industriel (→ EN 55011/22 classe A).
L'apparecchio è adatto per uso in ambienti industriali (→ EN 55011/22 Classe A).
El aparato es adecuado para uso en ambiente industrial (→ EN 55011/22 clase A).

Abmessungen – Dimensions – Dimensioni – Dimensiones [mm]

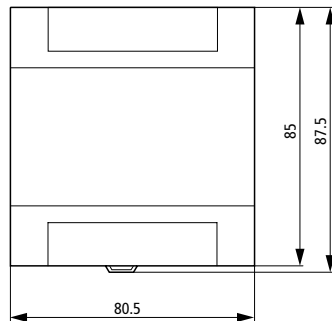
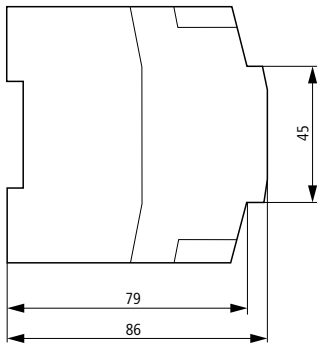

UL/CSA

Power Supply	# of channels and Input Rating	# of channels and Output Rating
24 V DC 0.1 A	–	8 relay, 2 A 240 V AC, 50/60 Hz 240 V AC, 1.5 A p. d. ¹⁾ 24 V DC, 2 A

1) p. d. Pilot Duty/Maximum operating temperature 55 °C/
Tightening torque 0.6 Nm/AWG 12-28

Frontansicht – Front view – Face avant – Vista frontale – Vista de frente

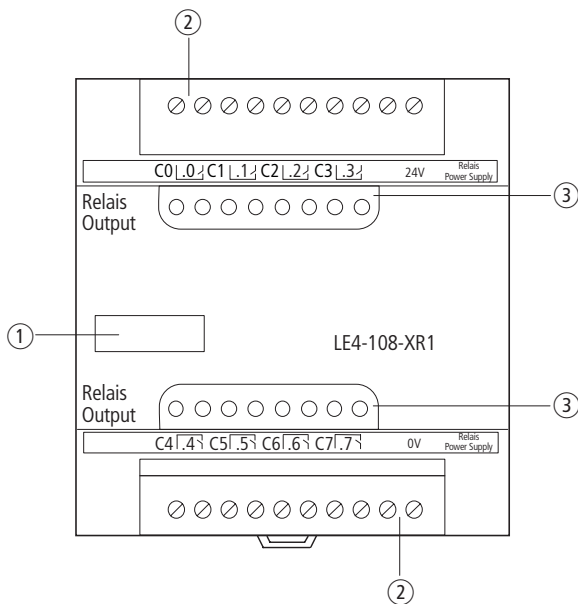

- ① Gerätekennzeichnung mit HAEG 18 × 6,5
- ② Steckbare Schraubklemme
- ③ Statusanzeige der Ausgänge

- ① Device label HAEG 18 × 6.5
- ② Plug-in screw terminal
- ③ LED status display for the outputs

- ① Identification d'appareils avec l'étiquette auto-adhésive HAEG 18 × 6,5
- ② Bornier à vis enfichable
- ③ Afficheur d'état DEL sorties

- ① Siglatura dell'apparecchio con HAEG 18 × 6,5
- ② Morsetto a vite sfilabile
- ③ Visualizzazione di stato a LED degli uscite

- ① Placa indicadora HAEG 18 × 6,5
- ② Terminal roscado enchufable
- ③ LED visualización salidas

02/00 AWA27-1306

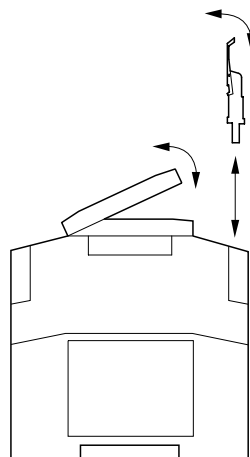
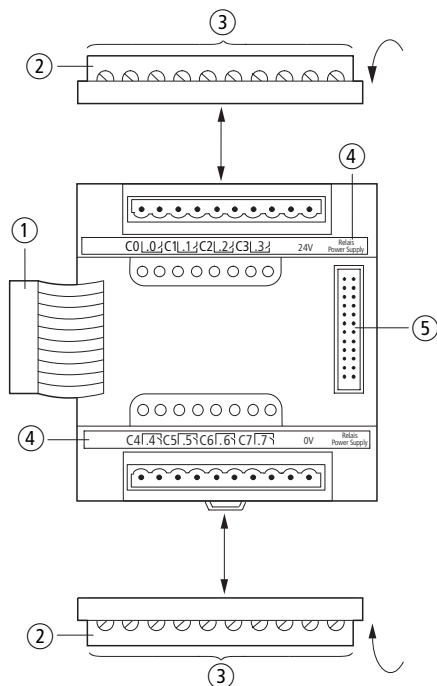

02/00 AWA27-1306

- ① Buchsenstecker
- ② Steckbare Schraubklemme
- ③ Anschlussquerschnitte:
 - feindrähtig mit Aderendhülse 0,22 bis 1,5 mm²
 - eindrähtig 0,22 mm² bis 2,5 mm²
- ④ Bezeichnungstreifen, Gehäuse
- ⑤ Stiftleiste

- ① Connettore femmina
- ② Morsetto a vite sfilabile
- ③ Sezione del cavo:
 - flessibile, con guaina 0,22 mm² a 1,5 mm²
 - rigido 0,22 mm² a 2,5 mm²
- ④ Targhetta per la siglatura, custodia
- ⑤ Attrezzo di codifica

- ① Socket connector
- ② Plug-in screw terminal
- ③ Terminal cross-sections:
 - flexible with ferrule 0.22 to 1.5 mm² (AWG 16)
 - with ferrule: 0.22 mm² to 2.5 mm² (AWG 13)
- ④ Terminal marking strip, housing
- ⑤ Plug connector

- ① Conector hembra
- ② Terminal roscado enchufable
- ③ Secciones de conexión:
 - flexible con casquillo 0,22 mm² a 1,5 mm²
 - marczico 0,22 mm² a 2,5 mm²
- ④ Tira indicadora, caja
- ⑤ Regleta de bornes

- ① Connecteur femelle
- ② Bornier à vis enfichable
- ③ Sections de raccordement :
 - avec embout : 0,22 mm² à 1,5 mm²
 - sans embout : 0,22 mm² à 2,5 mm²
- ④ Etiquette de repérage, boîtier
- ⑤ Bornier

Montage – Fitting – Montaggio – Montaje

auf Montageplatte mit 35-mm-Hutschiene ① (waagrecht)
on mounting plate with 35 mm top-hat rail ① (horizontal)
sur plaque de montage avec profilé-support 35 mm ① (horizontal)
su piastra di montaggio con guida DIN 35 mm ① (orizzontale)
sobre placa de montaje con guía simétrica de 35 mm ① (horizontal)

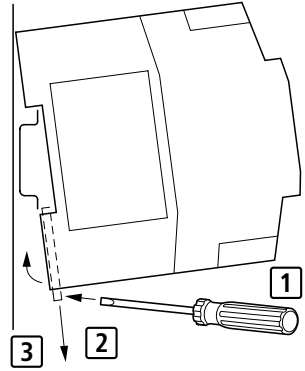
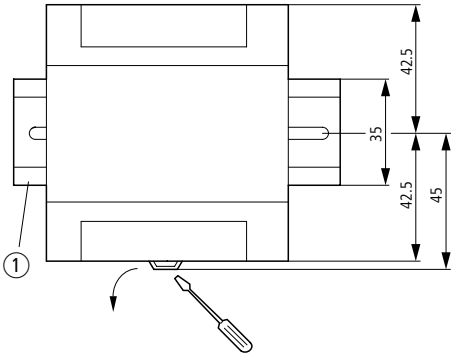

02/00 AWAZ7-1306

auf Montageplatte (waagrecht)
on mounting plate (horizontal)
sur plaque de montage (horizontal)
su piastra di montaggio (orizzontale)
sobre placa de montaje (horizontal)

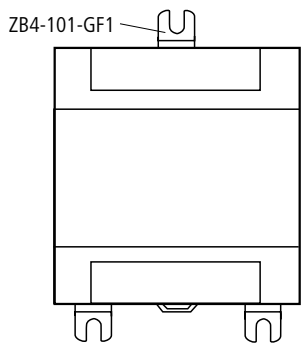
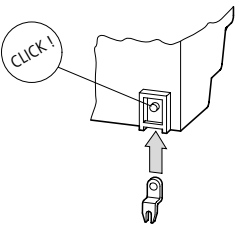

Bohrschablone M 1 : 1

Template for holes, scale 1 : 1

Gabarit de perçage, échelle 1 : 1

Dima di foratura, scala 1 : 1

Plantilla para taladros, escala 1 : 1

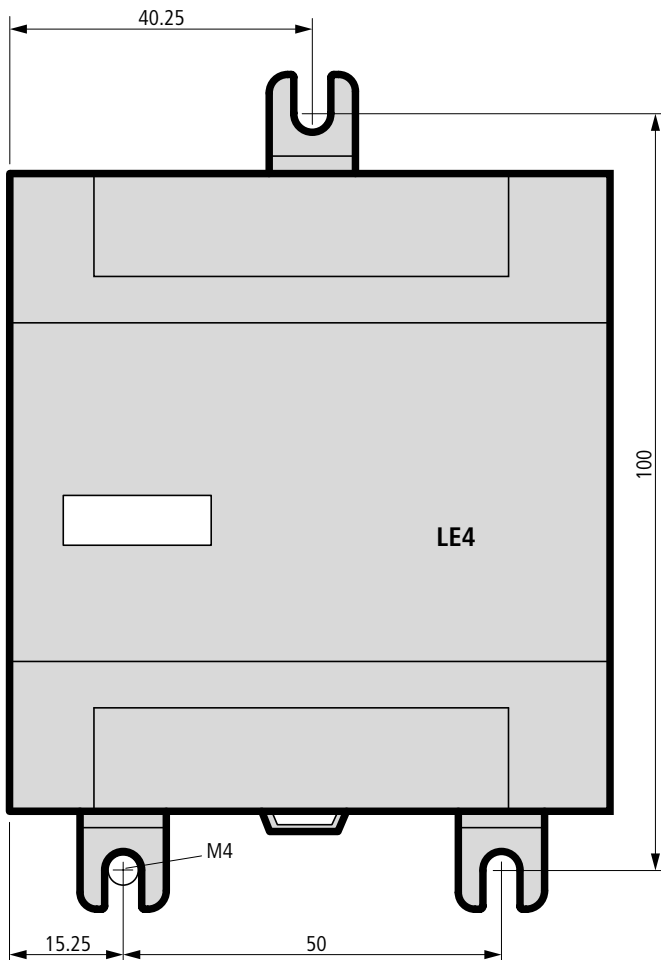

02/00 AWA27-1306